

TECHNICAL INFORMATION 5.0.7

PC



PC 2685-3 Glazing element

For horizontal and vertical glazings

made of Polycarbonate (PC)

makrolon®

makrolon®

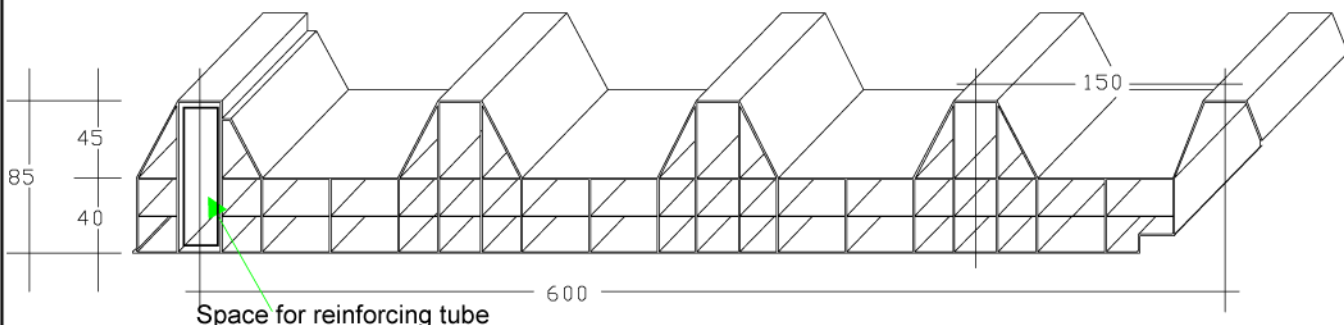

Product description

The type PC 2685-3 is an insulating glazing mounted with corresponding Alutherm-sandwich roofing panels. The panels are mounted from ridge to eave in a complete length of up to 21 m.

Mounted alone this panel also offers the advantage of allowing day light into the building as well as having a high insulation value.

By ridge and eave mounting the panel can be fitted with a form profile which allows it to be mounted onto almost all alu sandwich and tin roofing.

Material characteristics

This panel is made of weather resistant UV stabilised Polycarbonate which has high impact resistance in high and low temperatures. The special integrated structure enables a diffused light to enter the building creating a comfortable working atmosphere.

Mounting

Rodeca has a wide range of corresponding accessories with which almost all application problems can be solved. Form pieces and sealing profiles are available for a wide variety of mounting situations.

Mounting areas

Vertical and horizontal glazings alternative to sky lights

Technical data		Unit	
PC 2685-3			
Building width	600	mm	
Element width	615	mm	
Thickness	40/85	mm	
Weight	6,00	ca. kg/qm	
U-value	1,55	W/m ² K	
Modulus of elasticity	2200	N/qmm	
Expansion coefficient	0,065	mm/m °C	
Temperature stability	short	130	°C
	long	115	°C
	long	-40	°C
Light transmission	clear	55	max. %
	opal antiblind	42	max. %
UV-transmission	0	%	
Ball impact	no damage		
Hail impact	no damage	EMPA-Norm	
Fire classification	B 2	DIN 4102	

Acceptable span widths:				
Facit distance in cm				with
senkrecht		Middle area	End area	reinforcement
0 - 8 m		250	200	310

Inclined surfaces*				
> 10 - 30°		150	150	pls. ask

*Values are valid for closed buildings for middle area and end area

Pls. ask for our complete construction details

*Gaurantee according to our guarantee

Pls. see our PC tech. Info for further details

The information is given in good faith but without commitment and no warrant is given or implied.

1.7.6.03

The application, use and processing of the products are beyond our control and therefore entirely your own responsibility.

TECHNICAL INFORMATION 5.0.7.0.1

Accessories

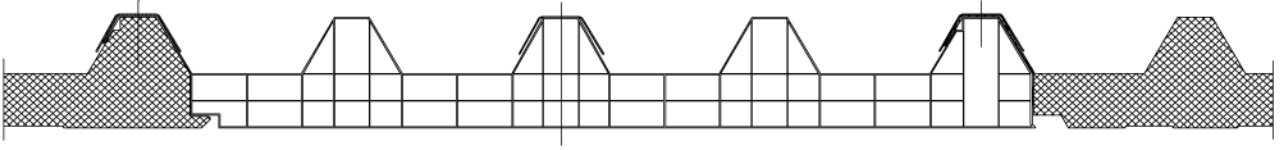

Combination glazing element with alu sandwich element

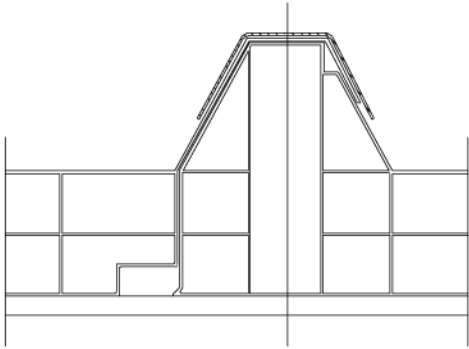

Details of the overlapping of two 2685-3 glazing elements fastened with a kallote fastener

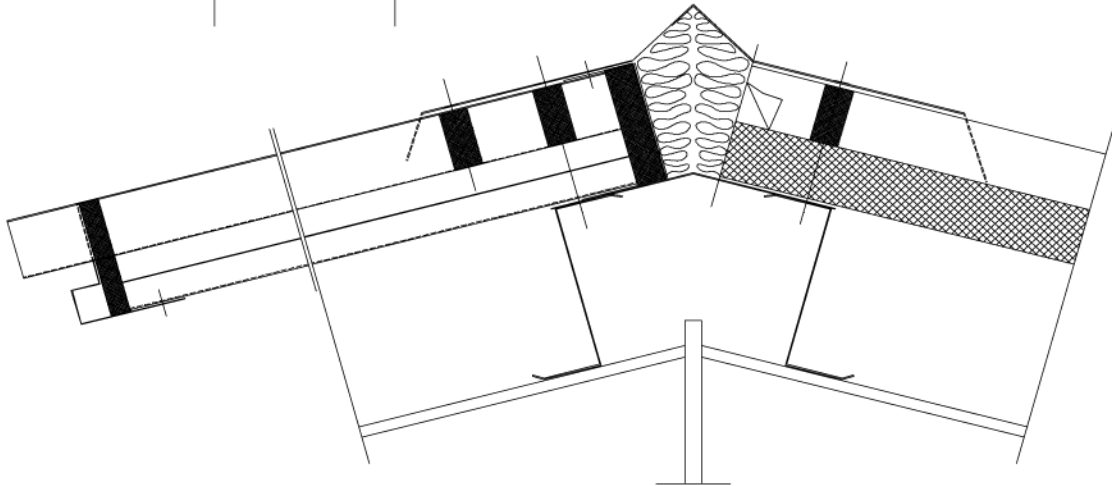

Detail peak

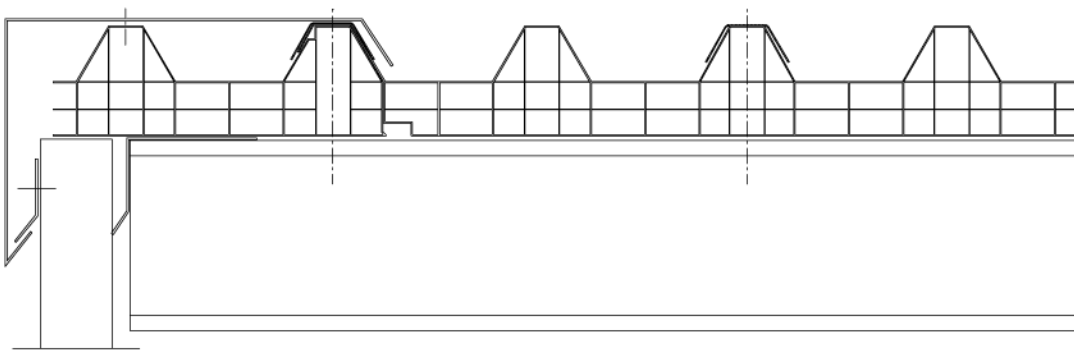

Detail corner

Please also check our technical information for PC